

The background of the cover features three Sunreef catamarans on the water. The boats are arranged in a diagonal line from the top left towards the bottom right. They have white upper decks and dark hulls. The water is calm with a slight ripple, and the sky is a soft, hazy orange and blue, suggesting a sunset or sunrise. The overall mood is serene and luxurious.

NEWS MAGAZINE Sunreef

Spring-Summer 2018

IN THE SPOTLIGHT:

NEW SUNREEF 50

**40 OPEN SUNREEF POWER:
THE WILDEST CAT JOINS THE FLEET**

SUNREEF SIDE OF CHARTER

SOFITEL GRAND SOPOT



POWSTAŃCÓW WARSZAWY 12/14
81-718 SOPOT, POLAND
TEL.: +48 58 520 60 00 - FAX: +48 58 520 60 99
E-MAIL: H3419@SOFITEL.COM
WWW.SOFITEL.COM/3419



Art Deco Restaurant

MY MAGNIFIQUE VOYAGE



Private beach

Life is Magnifique in Sopot!



Sofitel Grand Sopot



SOFITEL
HOTELS & RESORTS

SOFITEL GRAND SOPOT

LUXURIOUS AND PRESTIGIOUS SOFITEL GRAND SOPOT IS AN IDEAL PLACE FOR A TRULY RELAXING AND REJUVENATING SEASIDE BREAK. AMONG EXCLUSIVE AMENITIES OUR ART DECO RESTAURANT WITH SEA VIEW OFFERS POLISH-FRENCH

CUISINE, FULL OF EXQUISITE CULINARY HIGHLIGHTS. TASTE OUR FRESHLY PREPARED BREAKFASTS, LIGHT LUNCHES AND GOURMET DINNERS INSPIRED BY THE TASTE OF FRANCE.

FIND OUT MORE: WWW.SOFITEL.COM  

Dear Friends,

My very best wishes go out to you as we enter the new year. I hope that 2018 brings you positive energy, health and happiness.

After an extremely busy and productive 2017, I can say that Sunreef Yachts has sailed through an exceptional year that has brought the company more than one reason to be proud. With the shipyard celebrating its 15th anniversary, we have marked this special occasion with a unique and unforgettable showcase at the Cannes Yachting Festival. Throughout 2017 Sunreef Yachts has received prestigious international awards, launched a spectacular custom-built 88ft Double Deck sailing superyacht and has introduced a completely new range of 80, 60 and 50 ft sailing catamarans, but most importantly, our shipyard has noted a significant increase in sales. With the end of December 2017 we have also completed the construction of our very first fast dayboat project - the 40 Open Sunreef Power, which will be premiered at the upcoming Dubai International Boat Show. With new construction facilities currently in development, the shipyard is looking forward to strengthening its production capacity very soon. Our plans for this year also include the introduction of an entirely new power catamaran concept, which should be a breath of fresh air to the market. Our efforts are as well focused on the organization of the 4th edition of our signature lifestyle event - the Pomorskie Rendez-Vous in Gdansk. In addition to all the nautical exhibitions that we plan to take part in, this event will be a great opportunity to step aboard our catamarans and meet our representatives in a friendly and relaxed atmosphere. To keep abreast of the latest with Sunreef Yachts, I encourage you to meet our team members at all those events, but also to follow the news on the company's website and social media channels. In the meantime, I wish you a very pleasant read.



Yours sincerely,
Francis Lapp
President and Founder of
the Sunreef Yachts Shipyard

A handwritten signature of Francis Lapp in black ink, written in a cursive style.

TABLE OF CONTENT

6 LATEST NEWS

38 EVENTS

38 RIGHT PLACE, RIGHT TIME – SUNREEF YACHTS 15TH ANNIVERSARY AT THE CANNES YACHTING FESTIVAL

44 CHARTER CORNER

46 NEW TO THE FLEET
47 – SUNREEF 62 ANETTE2
50 – 70 SUNREEF POWER MOONDANCE
52 CROATIA, BEAUTY AND DIVERSITY
58 ON THE SUNREEF SIDE OF CHARTER

14 NEW CONCEPT

14 NEW SUNREEF 50 A SMART LUXURY CATAMARAN

22 NEW LAUNCHES

22 SUNREEF SUPREME 68 POWER GOLD SEAHORSE – AN EXCLUSIVE USA PREMIERE
32 SUNREEF SUPREME 68 POWER CHRISTINA TOO – THE WAVE CUTTING CAT



SUNREEF YACHTS SUNREEF VENTURE S.A.

Doki 1, 80-958 Gdańsk, Poland
TEL: +48 517 254 853
info@sunreef-yachts.com
NIP PL: 522-30-59-783

SNM PROJECT COORDINATOR

Karolina Paszkiewicz
PR&Marketing Director at Sunreef Yachts
karolina@sunreef-yachts.com

EDITORIAL

Artur Połoczański
artur@sunreef-yachts.com

GRAPHIC DESIGNER

Marcin Trzaska
marcin.trzaska@sunreef.com



SUNREEF YACHTS CHARTER

TEL: +33 970 447 052
TEL: +48 58 776 23 16
charter@sunreef-charter.com

ADVERTISING

Marta Śledziewska
marta.sledziewska@sunreef-yachts.com
Anna Sikorska
anna.sikorska@sunreef-yachts.com

SUNREEF YACHTS CHARTER CORNER

Julia Pietruszka
julia@sunreef-yachts.com

A WILD CAT JOINS

LET'S WELCOME THE

THE RANGE!

40 OPEN SUNREEF POWER



Photography:
Bartosz Modelski



Sunreef Yachts enters the market of superyacht tenders and day cruisers with a very exciting product. With a beamy multihull structure and folding bulwarks the 40 Open Sunreef Power has unbelievable amounts of lounging space and is naturally balanced at high speeds. Our Dubai premiere will feature the model's planing hull version, but we are already working on its hydrofoil edition. We never stop!

Francis Lapp – Sunreef Yachts Founder and President



Sunreef Yachts has launched the 40 Open Sunreef Power – a dynamic day cruiser taking speed and luxury to a whole new level. Following her launch and tests, this radical multihull speedster is to debut at the Dubai International Boat Show 2018.

With a well-equipped bar, state-of-the-art sound system, a big sun awning, fishing rods and clever storage all around, the 40 Open Sunreef Power is a fully customizable craft. The model's hulls offer enough volume for a spacious bathroom and a utility room. The open bow section can also be used for a comfortable cabin with a double bed. The first 40 Open Sunreef Power to be presented in Dubai is equipped with two IPS 600 (2x435HP).



**GENERAL CHARACTERISTICS
40 OPEN SUNREEF POWER**

| | |
|--------------------|----------------------|
| LENGTH OVERALL | 12.75m / 40ft |
| MAXIMUM BEAM | 5.2m / 17ft |
| DRAFT | 0.7m / 2.3ft |
| ENGINES | 2x IPS 600 (2x435HP) |
| MATERIAL | Advanced composites |
| CATEGORY | B and C |
| NAVAL ARCHITECTURE | Sunreef Yachts |
| DESIGN | |

AN EXCITING BOAT SHOW SEASON AHEAD FOR SUNREEF YACHTS

SUNREEF EVENTS CALENDAR

FEBRUARY 15th – 19th



FEBRUARY 22nd – 25th



FEBRUARY 27th – MARCH 3rd



APRIL 12th – 15th



MAY 24th – 27th



Sunreef Yachts 2018 boat show calendar takes the company's custom catamarans to the world's most exclusive marine events. After showcasing the Sunreef 82 Double Deck *Houbara* at the Phuket Rendez-Vous with Sunreef Yachts Thailand – Infinite Yachts, the shipyard will bring the Sunreef Supreme 68 Power *Gold Seahorse* to the Miami Yacht Show. Next, teaming up again with Infinite Yachts, Sunreef Yachts will take part in the Thailand Yacht Show.

Two of the shipyard's luxury catamarans are to participate in the Dubai International Boat Show. The showcase will include the international premiere of the 40 Open Sunreef Power: a dynamic and extremely stable dayboat with strong focus on lifestyle and fast cruising. The Sunreef Supreme 68 Power *Athena* is also joining the exhibition for her official UAE debut.

After Dubai, Sunreef Yachts heads over to Singapore to take part in the Singapore Yacht Show to later exhibit at Australia's Sanctuary Cove Boat Show together with the company's local dealer, Vicsail. ■



THE SUNREEF 88 DOUBLE DECK WINS THE CHRISTOFLE YACHT STYLE AWARD

Sporty and seaworthy, with 300m² of living space, the Sunreef 88 Double Deck was recognized as the Best Multihull over 15m at the Christofle Yacht Style Awards on June 4th, 2018. Launched by the Yacht Style magazine and held during the Phuket Rendez-Vous, this prestigious event aims to reward the most original recent crafts on the global yachting scene.

Sunreef Yachts Thailand – Infinite Yachts representatives, Dominique Machtelinckx and Giovanni Toumi have received the award on the shipyard's behalf during a special gala dinner gathering an audience of VIPs and key industry personalities.

Launched mid-2017 as Sunreef Yachts sixth superyacht construction, the Sunreef 88 Double Deck is the most recent edition of the Double Deck concept, introduced with the 102-footer *Ipharra*. All yachts in this range feature a mezzanine level inside the saloon and a spacious master stateroom with a panoramic view in the bow part of the main deck. The yacht's layout, interior design and technical features were entirely tailored to her Owner's exact expectations. ■



TWO SUNREEF YACHTS NOMINATED FOR THE MULTIHULL OF THE YEAR AWARD

The Sunreef Supreme 68 Power and Sunreef 88 Double Deck have been nominated for the Multihull of the Year award. The first edition of this competition organized by the Multihulls World magazine recognizes the best and most innovative yachts in the international multihull industry.

With the competition now under way, we encourage you to visit the Multihull of the Year 2018 website and vote for the Sunreef 88 Double Deck in the **More than 50 feet** category and the Sunreef Supreme 68 Power in the **Power cat** category. ■



INVESTING IN GOLD

SUNREEF YACHTS SUPPORTS YOUNG SAILING TALENT KACPER STANISLAWSKI

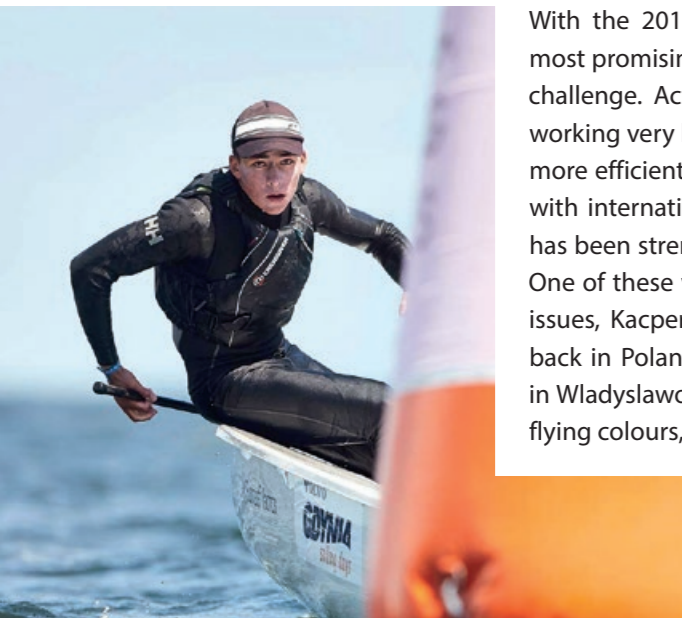

With the 2017 competition season now over, Kacper Stanislawski, one of Poland's most promising young sailing talents, reflects on a busy year filled with hard work and challenge. Actively supported by Sunreef Yacht throughout 2017, Kacper has been working very hard on his debut in the Laser Standard Olympic class. Adapting to a new, more efficient but demanding sail type, he has been combining long Winter workouts with international training sessions. While in France and Spain, the sailing rising star has been strengthening his overall skills to prepare for upcoming global competitions. One of these was the European Cup in Hyères, where despite tackling some technical issues, Kacper has managed to complete a couple of races with good results. Once back in Poland, he engaged in local events, including Poland's Junior Championship in Wladyslawowo on the Baltic coast. The 17-year old sailed through the regattas with flying colours, concluding the race with a silver medal in hand.

“The last season was particularly demanding, as it involved switching to a completely new sail boat class. The efforts that I have put in my preparations are now beginning to pay off. I am very happy that I have Sunreef Yachts' support and I hope the next season brings even more success.”

Next came the preparations for the European Championship, involving rehearsals in Poland and during the world-famous annual Kiel-Week. While in Poland, Kacper has competed in Sprint Regattas gathering the country's most skilled sailors, coming away with silver again. Around mid-July, the races carried on in France, which have brought the young talent the confidence and experience needed to face the challenge of the 2018 European Championship. Further preparations also included the European Cup in Dziwnow, where Kacper ended as gold medallist among juniors. The young sailor has also participated in the Polish Championship in Puck, finishing 6th and has taken part in the finals of the Polish Cup in Gizyck, ending 4th, which has placed him in 3rd position in Poland's overall ranking. ■

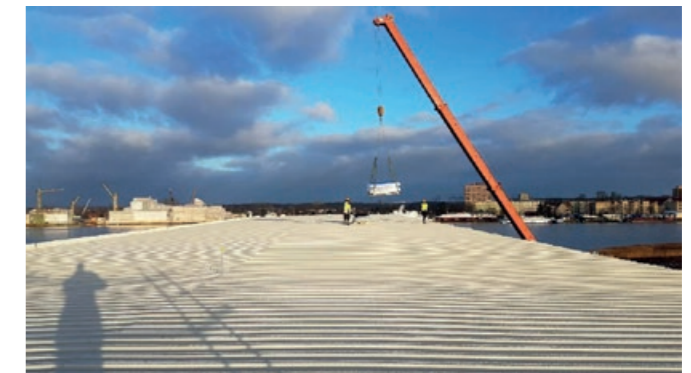

Photo: Kacper Stanislawski

NEW FACILITIES UNDER CONSTRUCTION!



The shipyard is building an all-new hall equipped with an ultramodern CNC system. The project is due for completion by the end of the first quarter of 2018. This construction will significantly enhance the shipyard's production capacity. With more and more orders received, Sunreef Yachts expands its facilities as part of a long-term investment. The current build will enable the company to respond to a growing demand, namely for the recently introduced new range of sailing catamarans.



NEW
CONCEPT



Bow terrace on board the Sunreef 50

NEW SUNREEF 50

A SMART LUXURY CATAMARAN

WITH THE SHIPYARD'S ALL-NEW SAILING CATAMARANS ACHIEVING A SPECTACULAR SUCCESS, SUNREEF YACHTS HAS EXTENDED ITS LATEST RANGE WITH A COMPACT LUXURY CATAMARAN – THE SUNREEF 50. SHE FEATURES ALL THE MAIN CHARACTERISTICS OF HER 60 AND 80-FOOT SISTERS, OFFERING SUPREME COMFORT, ELEGANT STYLING AND PLENTY OF OPTIONS FOR CUSTOMIZATION WITHIN A 50-FOOT HULL.



The NEW Sunreef 50

With her classically inspired exterior design she is easily spotted from afar thanks to her sleek line. The yacht's raised bulwarks and generous teak use contribute to her timeless and authentic marine character. The Sunreef 50's superstructure was specifically designed to enhance onboard comfort. Her saloon opens both onto the comfortable bow terrace and the yacht's cockpit which is extended with a hydraulic aft platform.

The hulls provide impressive volumes to set up a custom layout including airy, luxurious guest cabins and an opulent master suite with a walk-in dressing, desk, sofa, retractable TV and an immense bathroom.

While housing the main helm, the large flybridge is definitely dedicated to leisure with more than enough space for a big dining table, a fully-equipped wet bar and large sunpads.



Aft cockpit with hydraulic platform on board the Sunreef 50



Saloon on board Sunreef 50 Amber Limited Edition



Amber en-suite bathroom



Amber master cabin

The Sunreef 50 Amber is a special, limited edition of this compact luxury catamaran. This key-in-hand version will only see 10 launches. The Sunreef 50 Amber Limited Edition catamarans include a carbon mast and boom and a complete pack of options perfectly adapted to worldwide cruises, carefully selected by Sunreef Yachts. The Amber package was based on feedback from customers from all over the world and offers four smart layouts to choose from as well as an exclusive design incorporating hand-crafted amber elements.

The Sunreef 50 has entered the market of smaller recreational multihulls as a luxury alternative for most of the compact crafts available. As part of Sunreef Yachts latest sailing range, she was created with the same philosophy that was applied to the concept of her bigger 60 and 80-foot sisters. While elaborating its new catamaran line, the shipyard's in-house designers have been looking for ways to express the spirit of a classic sail yacht through modern marine architecture. As the first drawings were made, the idea became clear. An all-around sailing leisure yacht range ideal for exclusive getaways, charter and transoceanic adventures emerged. Purity, space and light are the essential elements of the range boasting a combination of exterior and interior areas easily flowing into one another. Offering premium quality and custom design, the Sunreef 50 is a tribute to all those who won't settle for a mass product. ■

NEW
CONCEPT



Sunreef Yachts NEW Range. From the left: Sunreef 80, Sunreef 60 and Sunreef 50

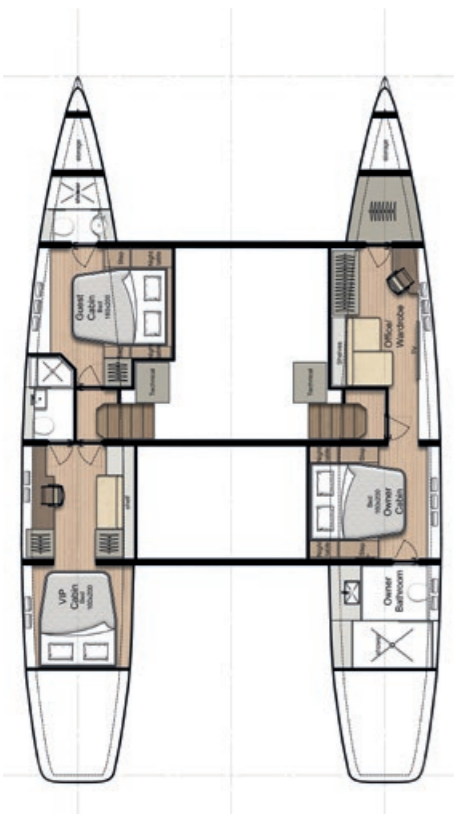

HULLS

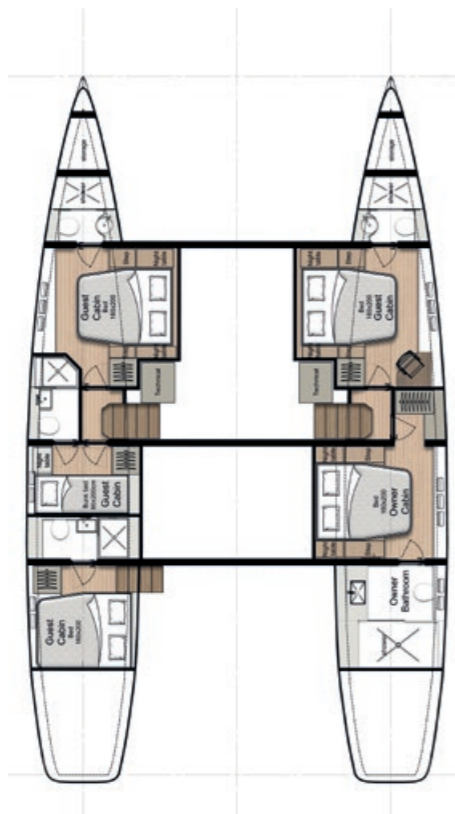

MAIN DECK

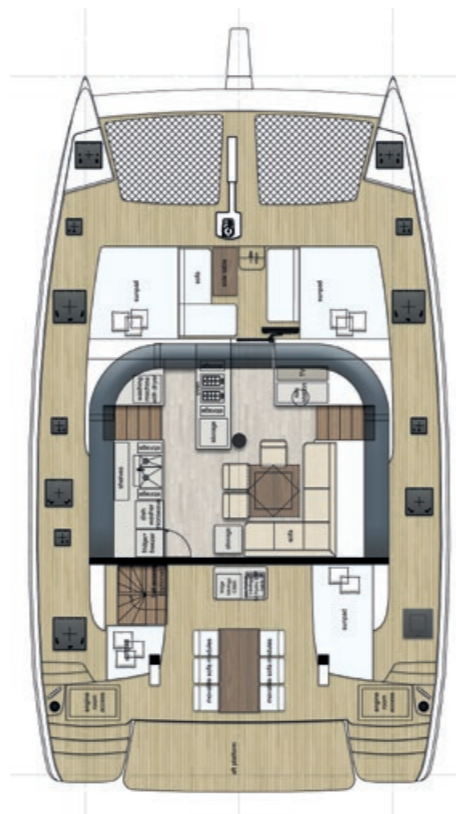

FLYBRIDGE

**GENERAL CHARACTERISTICS
SUNREEF 50**

| | |
|--------------------|---|
| CONSTRUCTION | COMPOSITE |
| LENGTH OVERALL | 15.2m / 50ft |
| BREADTH OVERALL | 9.1m / 30ft |
| DRAFT | 1.1m / 3.7ft |
| ENGINES | 2 x 80HP |
| FUEL CAPACITY | 1000L / 264 US gal |
| WATER CAPACITY | 800L / 211 US gal |
| MAINSAIL | 75m ² / 807ft ² |
| GENOA | 55 m ² / 592 ft ² |
| TOTAL LIVING SPACE | 300m ² / 325ft ² |
| GUESTS | 12 |
| CATEGORY | A |
| NAVAL ARCHITECTURE | Sunreef Yachts |
| DESIGN | |

NEW
LAUNCHES

SUNREEF SUPREME 68 POWER GOLD SEAHORSE

AN EXCLUSIVE USA PREMIERE

Photography:
Jeff Brown / Breed Media

View from the Sunreef Supreme 68 flybridge



SUNREEF YACHTS HAS BROUGHT ONE OF THE SHIPYARD'S SPECTACULAR SUNREEF SUPREME 68 POWER CATAMARANS TO THE FORT LAUDERDALE INTERNATIONAL BOAT SHOW 2017. MAKING HER AMERICAN DEBUT, *GOLD SEAHORSE* HAS ATTRACTED QUITE SOME ATTENTION, CAPTIVATING THE VISITORS WITH HER AMAZING AMOUNTS OF CUSTOM-DESIGNED LIVING SPACE, HER VAST SUPERYACHT-STYLE SALOON AND IMPRESSIVE DINGHY GARAGE.





Spacious saloon



The Sunreef Supreme 68 Power's first USA showcase has demonstrated how this model's unique features match the needs of the local yachting scene, paying much attention to onboard comfort. In fact, one of the yacht's main characteristics that have seduced the North American yachtsmen is *Gold Seahorse's* immense saloon.

The area was given a soothing décor with dominating white and beige tones. The fine Italian furniture and chrome details blend in perfectly with the interior, while the floor-to-ceiling glazing with doors opening onto the aft and the sides, gives the lounging space an unbelievable airiness and invite plenty of sunlight inside.



Master cabin



En-suite bathroom

The central seating with a generous C-shaped sofa neighbouring the vast harmonica door offers a spectacular sea view. To portside, a quartz-finished bar is fitted, just a few steps away from the yacht's well-equipped galley, occupying a part of the saloon's bow section together with a dining table for eight. A cosy chaise longue found its way next to one of the lateral doors to create a dream lounging and reading spot. A 55"TV was mounted on a drop-down system, blending seamlessly with the ceiling.

Gold Seahorse accommodates for eight adult guests all together, thanks to her practical and family-friendly layout including three roomy guest cabins, all with luxurious en suite bathrooms, clever storage, TVs and queen size beds. The opulent master suite features a drop-down TV, a generous dressing, a toddler bed and voluminous bathroom with an elegant quartz finish.



Flybridge

Up on the flybridge is where the Owners and their guests like to gather for lengthy alfresco get-togethers. The sundeck's outstanding surface offers vast seating and sunning areas with easy access to the bar. *Gold Seahorse's* full-beam bow terrace, entirely finished in teak, features a Jacuzzi. Possibly the best spot one could think of to conclude a long day in the sun. ■



SUNREEF SUPREME 68 POWER GOLD SEAHORSE – LAYOUTS

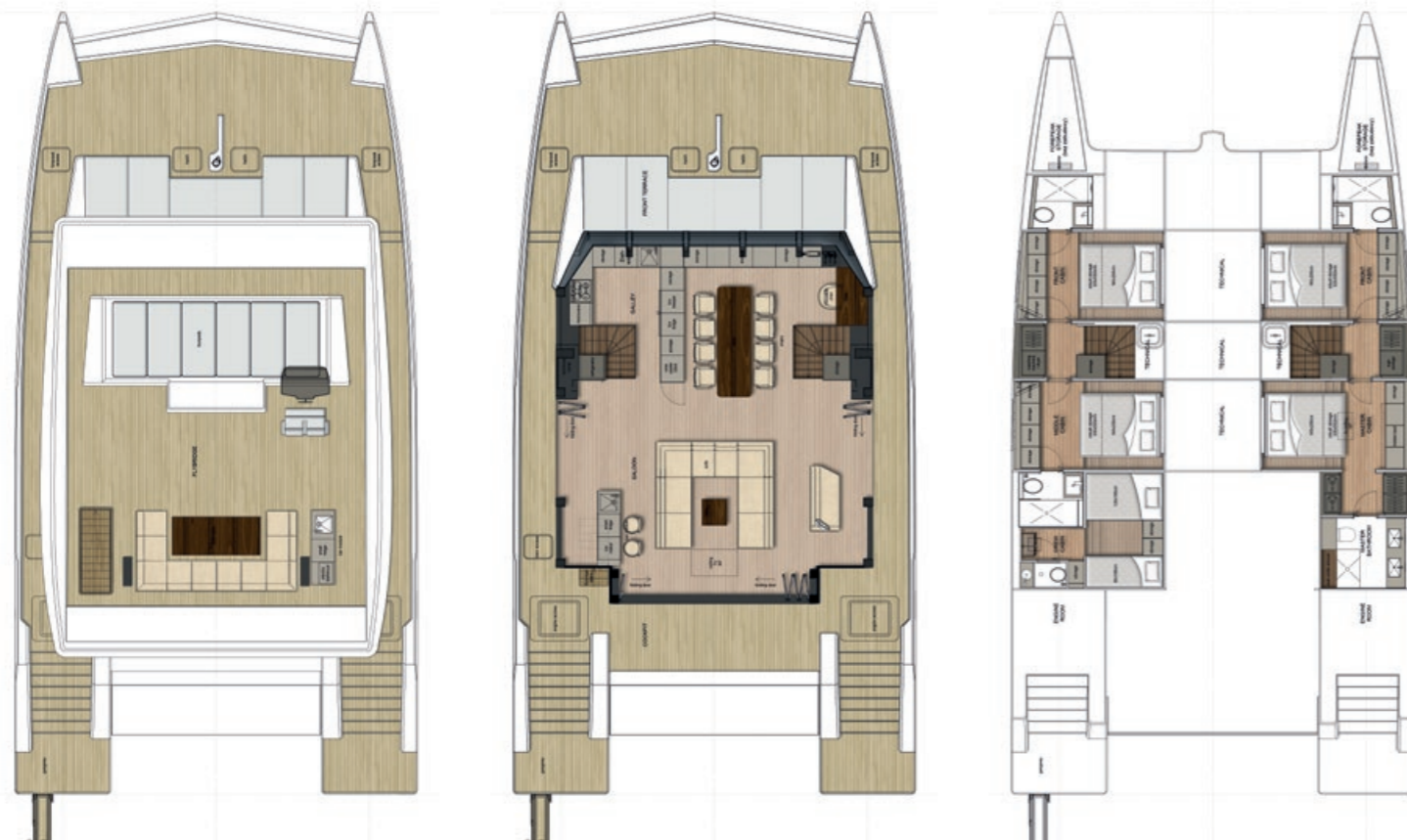

FLYBRIDGE

MAIN DECK

HULLS

| GENERAL CHARACTERISTICS SUNREEF SUPREME 68 POWER GOLD SEAHORSE | |
|---|---|
| CONSTRUCTION | COMPOSITE |
| LENGTH OVERALL | 20.5m / 67.1ft |
| BREADTH OVERALL | 10.5m / 34.5ft |
| DRAFT | 1.1m / 3.7ft |
| ENGINES | 2 x VOLVO IPS 1050 |
| FUEL CAPACITY | 7000L / 1849 US gal |
| WATER CAPACITY | 1000L / 264 US gal |
| TOTAL LIVING SPACE | 300m ² / 3250ft ² |
| GUESTS | 12 |
| NAVAL ARCHITECTURE | Sunreef Yachts |
| DESIGN | |

ART DEAREST TO POLES

Poles are no longer afraid to invest in art. The market has gained incredible momentum. Only last year, a sum of PLN 4.3 million was paid for Wyspiański's painting, and 3.7 million for the canvas by Matejko, while the entire market recorded 30% growth.



JULIUSZ WINDORBSKI - DESA UNICUM AUCTION HOUSE CEO SINCE 2003, ART COLLECTOR, THE MOST RENOWNED AUCTIONEER IN POLAND. UNDER HIS LEADERSHIP, IN JUST A FEW YEARS, DESA UNICUM HAS BECOME THE LARGEST COMPANY ON THE POLISH ART MARKET. TODAY, ITS SHARE IN THE AUCTION MARKET IN POLAND AMOUNTS TO 43.7%.

IT SEEMS WE HAVE HAD A REMARKABLE YEAR ON THE ART MARKET

JULIUSZ WINDORBSKI: Yes, in terms of record-breaking results, 2017 was definitely unprecedented. We exceeded the threshold amount of PLN 200 million in turnover - a limit unattainable ever before. Market value growth amounted to nearly 30%. It is really a lot. Please note that before 2010, turnover would amount to PLN 70-90 million.

WE HAVE WAITED FOUR YEARS FOR THE HIGHEST PRICED POLISH PAINTING.

JULIUSZ WINDORBSKI: Last year we had two record-breaking auctions, both at DESA Unicum. First, in June, the sum of PLN 3.7 million was paid for Jan Matejko's painting "The murder of Wapowski during Henri de Valois coronation". In December, another record was broken - PLN 4.3 million for "Maternity" by Stanisław Wyspiański. However, it was the end of the year that exceeded all expectations. The market gained momentum in November and December; on the auction titled Contemporary Art the most expensive artworks included those by Tadeusz Kantor, Henryk Stażewski, Tadeusz Brzozowski, and Erna Rosenstein. The auctions alone brought nearly PLN 17 million in turnover. Such a large number of record-breaking sales over such a short period of time happened for the first time on the Polish art market. It brings us to the point where the sum of one million zlotys someone is willing to pay for a painting is no longer striking.

DOES POLISH ART MARKET REFLECT GLOBAL TRENDS?

JULIUSZ WINDORBSKI: It is difficult to compare our market with the rest of the world when only this year in the USA one painting was sold for \$ 450 million. The Louvre Museum opened in Abu Dhabi cost one billion dollars according to estimates. The prices quoted on the domestic market are still just a fraction of those traded abroad. But Polish market is definitely one of the most dynamically developing in the world. Last November, we opened a new DESA Unicum premises at Piękna Street in Warsaw. The place combines a site for trading artworks with public cultural institution. It is a sensation on a European scale, and it has a positive impact on the perception of the entire market. Investors can see that selling works of art may be profitable.

ARE POLISH ARTISTS WORTH INVESTING IN?

JULIUSZ WINDORBSKI: Definitely yes. There are many very good artists in Poland who are still underappreciated. Obviously, few people can afford to buy foreign artists' artworks worth millions of dollars. This underestimation is also evidenced by the fact that the value of works of art on the domestic market is constantly growing. The return is higher than on any other type of investment. Ten years ago, Alina Szapocznikow's sculptures would cost PLN 5,000-10,000 and currently they are quoted several hundred thousand euros, while major works of art may be sold for as much as one million euros! Only 4-5 years ago, one could buy a painting by Fangor for PLN 100 thousand. Today, one can expect a five-fold return on such investment. People who bought paintings by Ryszard Winiarski for PLN 30-40 thousand seven years ago now can sell them at PLN 200 thousand. It is beyond question that nowadays more and more Poles are investing in art. Such activity is no longer considered extravagant. Investors are aware that they need to wait just 7-10 years for the painting to multiply its value.

UPCOMING AUCTIONS AT DESA UNICUM AT PIĘKNA 1A ST. WARSAW:

- GRAPHIC ART, PRINTS & MULTIPLES, 15 FEBRUARY 2018, 7:00 PM
- 19TH CENTURY & MODERN ART: WORKS ON PAPER, 22 FEBRUARY 2018, 7:00 PM
- POST-WAR & CONTEMPORARY ART, 1 MARCH 2018, 7:00 PM
- 19TH CENTURY & MODERN ART, 15 MARCH 2018, 7:00 PM

More at: www.desa.pl



JAN MATEJKO (1838 Cracow - 1893 Cracow)
„The murder of Wapowski during Henri de Valois coronation”, 1861
oil on canvas, 132,5 x 101 cm



STANISŁAW WYSPIAŃSKI (1869 Cracow - 1907 Cracow)
Maternity, 1904
pastel on paper, 62 x 47,4 cm

SUNREEF SUPREME 68 POWER THE WAVE-CUTTING CAT



Photography:
Fotomohito

FAST, STABLE AND LUXURIOUS, THE SUNREEF SUPREME 68 POWER *CHRISTINA TOO* ENTERS THE FLEET AS THE MOST ADVANCED EDITION OF THE SUNREEF SUPREME. SHE BOASTS AN AMAZING TRIFECTA OF STATE-OF-THE-ART TECHNOLOGY, BOLD STYLING AND PERFORMANCE.

Commissioned by an adventurous African couple with ambitious navigation plans, the ultramodern catamaran *Christina Too* offers her Owners the best of safety, comfort and speed. Powered by two IPS Volvo 1050 (2 x 800 HP) and equipped with dynamic positioning, she is a pleasure to handle and maneuvers easily in crowded marinas. At sea, her set of wave piercers and dynamic trim control system allow for optimized performance with over 25 knots of maximum speed in all stability.

Night vision cameras, 360° thermographic camera, in-built tender refueling system, impressive freezing volumes, battery-powered air conditioning – *Christina Too* takes care of her Owners and guests day and night. While much attention was given to practical aspects and low maintenance, this Sunreef Supreme 68 Power also knows a lot about hospitality. The yacht's bow terrace is fitted with a big sun awning stretching over the entire lounging area comprising large sunbeds and a Jacuzzi. Two well equipped bar modules are installed on the vast flybridge providing plenty of space for dining and sunning.



Sunreef Supreme Christina Too during the sea trials in the Baltic Sea



Saloon



Navigation board



Flybridge

Christina Too accommodates for 8 guests thanks to her smart layout including two master suites with generous quartz-clad bathrooms and two guest cabins. Her vast main deck featuring a full beam galley and saloon was given a bright custom décor combining grey and cream tones with contrasting colorful furniture. A state-of-the-art surround system sets the mood in the 65m² living space along with a dropdown 55" TV.

The Sunreef Supreme 68 is the world's only 68-foot yacht model equipped with a superyacht dinghy garage and boasting 300m² of living space. *Christina Too* is using this potential expertly, but most importantly she is one of a kind and expresses her Owners' quest for adventure and life at sea. ■



Galley up



Saloon



NEW
LAUNCHES



Master cabin



VIP Cabin



En-suite bathroom

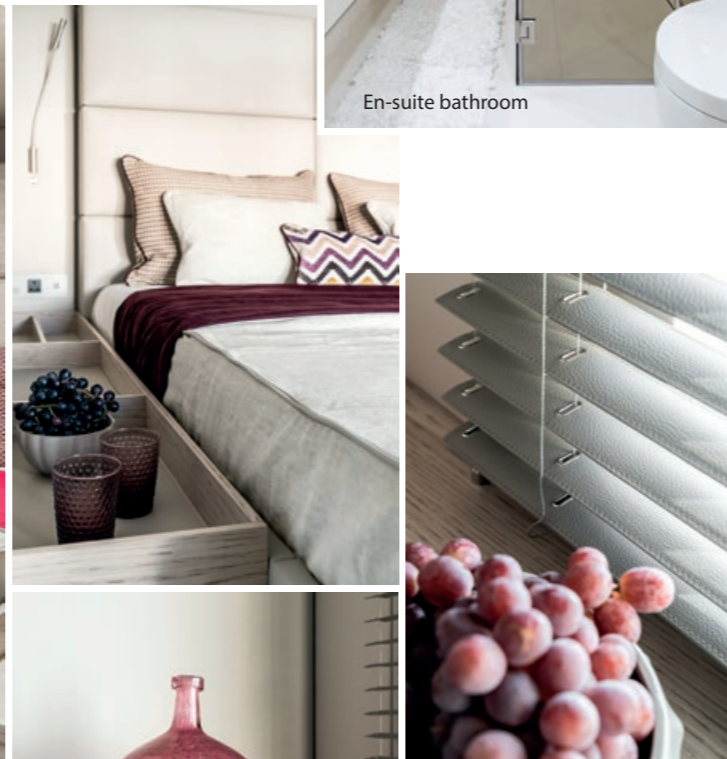

SUNREEF SUPREME 68 POWER CHRISTINA TOO – LAYOUTS

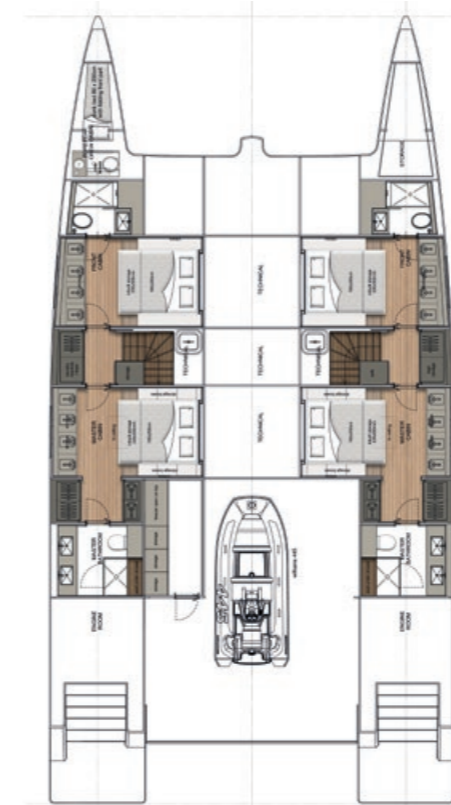

HULLS



MAIN DECK



FLYBRIDGE

GENERAL CHARACTERISTICS SUNREEF SUPREME 68 CHRISTINA TOO

| | |
|--------------------|---|
| CONSTRUCTION | COMPOSITE |
| LENGTH OVERALL | 20.5m / 67.1ft |
| BREADTH OVERALL | 10.5m / 34.5ft |
| DRAFT | 1.1m / 3.7ft |
| ENGINES | 2 x VOLVO IPS 1050 |
| FUEL CAPACITY | 7000L / 1849 US gal |
| WATER CAPACITY | 1000L / 264 US gal |
| TOTAL LIVING SPACE | 300m ² / 3250ft ² |
| GUESTS | 12 |
| NAVAL ARCHITECTURE | Sunreef Yachts |
| DESIGN | |

RIGHT PLACE RIGHT TIME

SUNREEF YACHTS 15TH ANNIVERSARY AT THE CANNES YACHTING FESTIVAL



Photography:
Jeff Brown / Breed Media





Last but not least, Sunreef Yachts officially unveiled an entirely new sailing range of catamarans during the annual press conference. With a classically inspired design and units ranging from compact to superyacht, the shipyard's new sail yacht offer is currently enjoying a massive success.



NEW Sunreef 60, scale model

THIS YEAR, SUNREEF YACHTS CELEBRATED THE SHIPYARD'S 15TH ANNIVERSARY THROUGHOUT THE CANNES YACHTING FESTIVAL. TO MARK THIS SPECIAL OCCASION, FOUR EXQUISITE CATAMARANS WERE SHOWCASED INCLUDING THE SUNREEF 88 DOUBLE DECK – THE BIGGEST MULTIHULL EXHIBITED AT THE VENUE. THE SUNREEF 62 ADEA, SUNREEF 74 CALMAO AND SUNREEF SUPREME 68 MARENGO HAVE JOINED THE SHOW FOR A UNIQUE AND UNFORGETTABLE SHOWCASE.



Press conference on board the Sunreef Supreme 68 Marengo

As every year, the lavish Sunreef Cocktail Party attracted numerous guests, journalists and industry professionals for a late night rendez-vous of celebration and live entertainment. A casual afternoon get-together for charter brokers was also organized by Sunreef Yachts Charter on board the luxury charter yacht Sunreef 74 Calmao. Sunreef Yachts representatives along with VIP guests have also joined the exclusive World Yacht Trophies Night gathering all the important names in the industry.

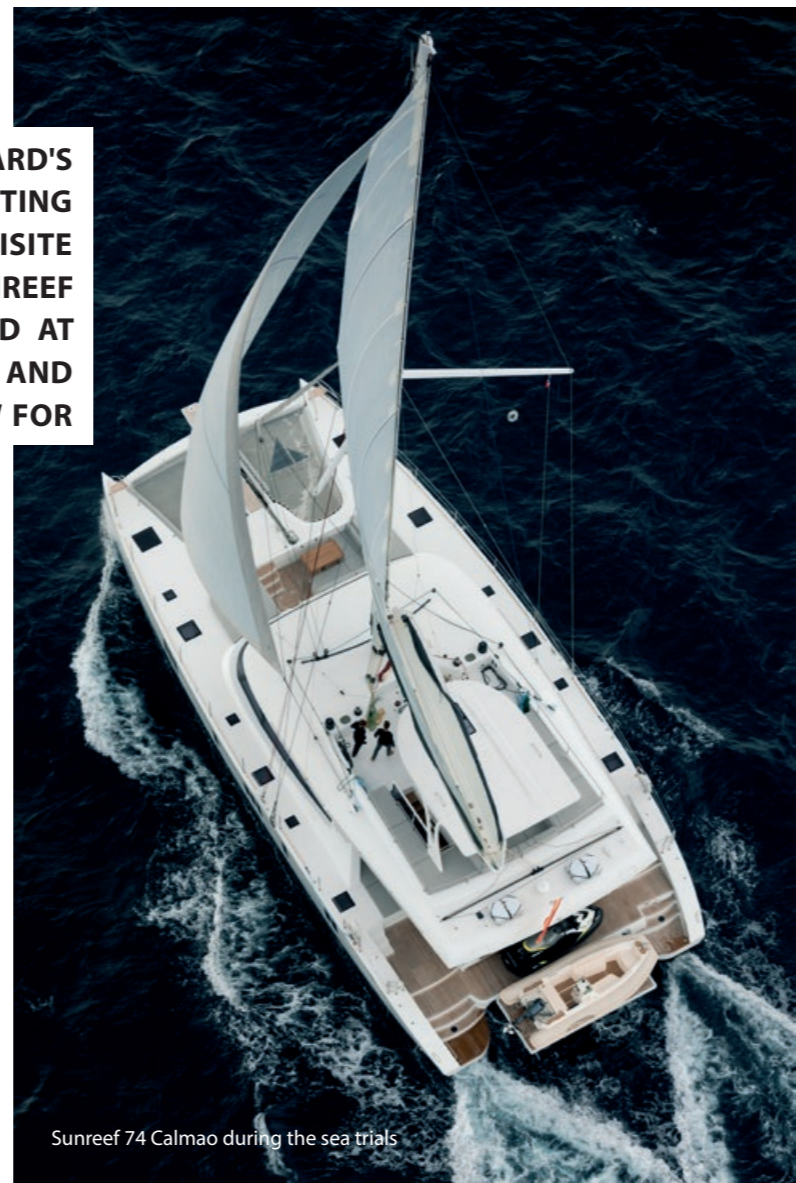

Sunreef 74 Calmao during the sea trials





1



2



3



5



4

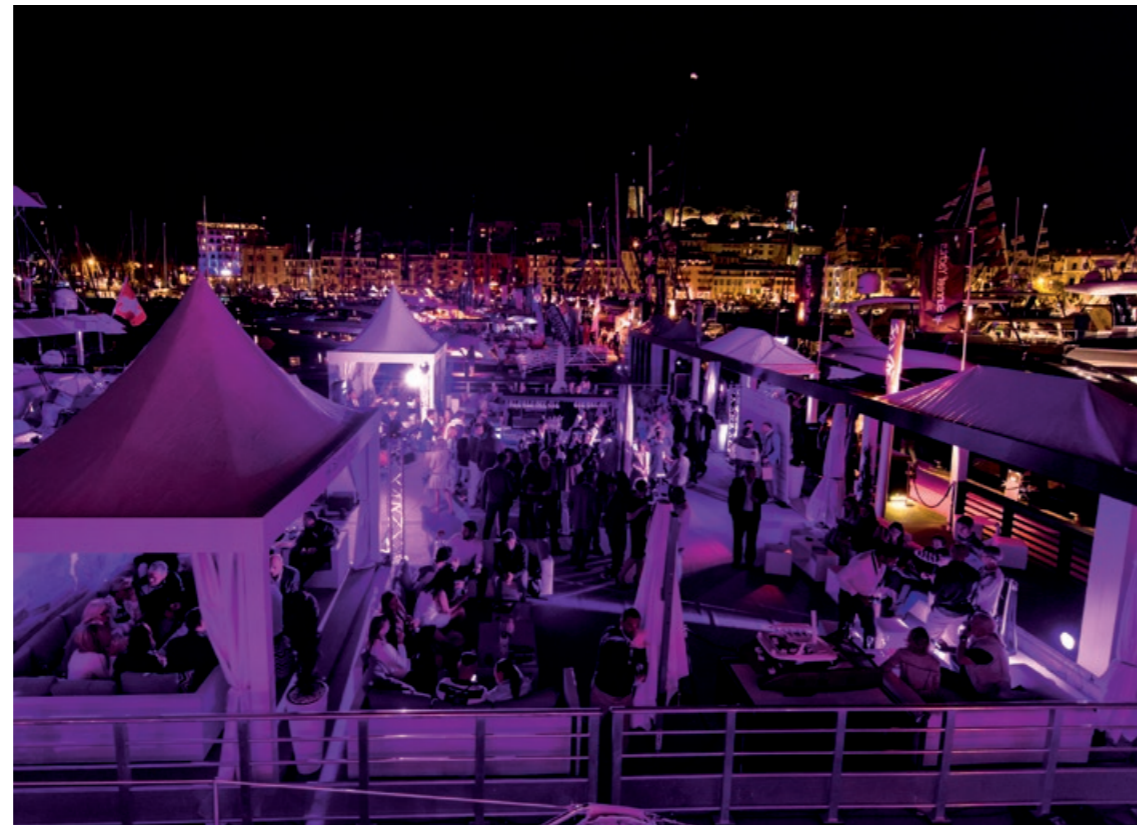

6

1. Francis Lapp with his wife Katarzyna Lapp
2. Sunreef Yachts Charter Team
3. Sunreef Yachts Design Team
4. Owners of the Sunreef 62 Adea
5. From the left: Olivier Chatelain, Dariusz Michalczewski with his wife Barbara, Katarzyna and Francis Lapp, Krystyna and Wicyslaw Kobylko, Hanna and Bogdan Goworowski
6. Sunreef Yachts Guests during the Yachts Trophies Gala dinner

SUNREEF YACHTS CHARTER CORNER

ESCAPE TO YOUR OWN SEASIDE PARADISE



WITH OVER A DECADE OF ACTIVE PARTICIPATION ON THE CHARTER MARKET, SUNREEF YACHTS CHARTER HAS NEVER CEASED TO AMAZE THE COMPANY'S INTERNATIONAL CLIENTELE WITH AN IMPRESSIVE VARIETY OF LUXURIOUS CHARTER CATAMARANS LOCATED IN THE MOST DESIRED YACHTING DESTINATIONS AROUND THE WORLD.

BEGINNING OF THE YEAR 2018 HAS BEEN MARKED BY TWO EXCEPTIONAL SUNREEF YACHTS CATAMARANS JOINING THE CHARTER FLEET – SUNREEF 62 ANNETTE2 AND 70 SUNREEF POWER MOONDANCE. THESE PROUD REPRESENTATIVES OF SUNREEF YACHTS CLASSIC MODELS WILL TREAT THEIR GUESTS TO UNFORGETTABLE CHARTER EXPERIENCES IN THE MOST EXOTIC SURROUNDINGS OF INDONESIA AND NEW ZEALAND.

ANNETTE2 SUNREEF 62

A grey-hulled beauty



With her grey hulls sliding through the Indonesian waters, *Annette2* is a sight one simply cannot miss. Her elegant silhouette is perfectly balanced with the yacht's outstanding seaworthiness and onboard comfort making her the ultimate choice within a 60-footer range.

With a meticulously designed charter layout comprising three double en suite cabins and a master suite, *Annette2* comfortably accommodates up to eight guests. The yacht's sublime interiors combine eucalyptus and cream tones with light blue accents for a contemporary marine look. Her vast saloon with a galley up introduces a welcoming atmosphere and provides a comfortable dining and seating area.

Exterior deck spaces of *Annette2* represent a variety of options for lounging in the sun, relaxing in the shade or dining in the picture-perfect surroundings. The yacht's professional crew of 2 will go above and beyond to provide their guests with a memorable sailing holiday while treating them to the most professional service and delicious cuisine.

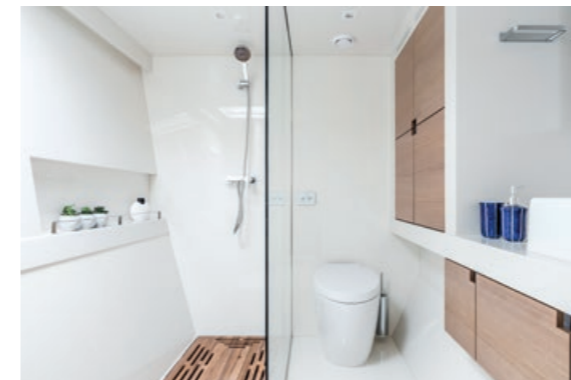
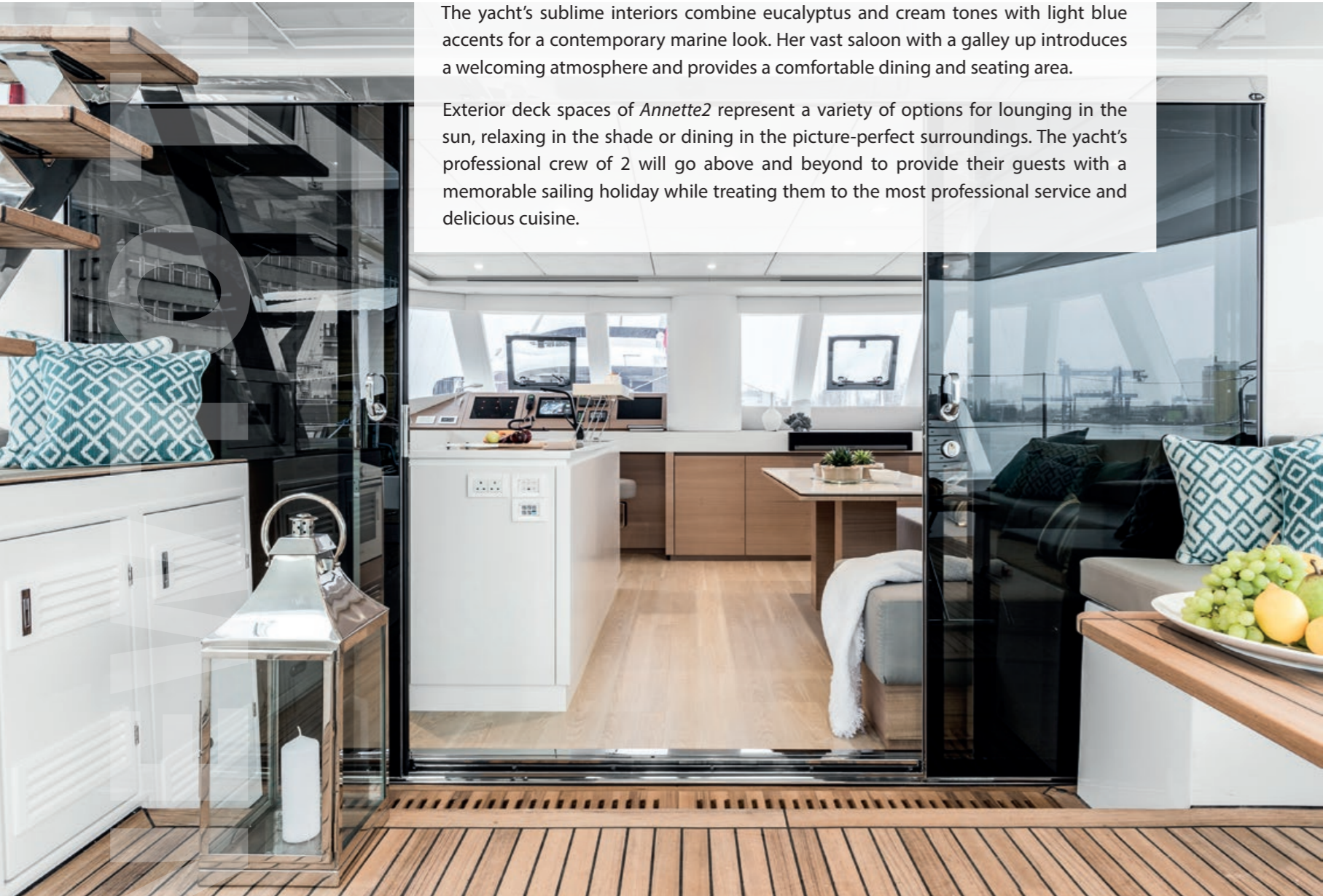

WEEKLY RATE AND SAILING AREA

Annette2

| | Location | Rate |
|-------------|-----------|----------------|
| 2018 / 2019 | Indonesia | from \$ 26,000 |

MOONDANCE 70 SUNREEF POWER

Powerful charter experience



Luxurious charter catamaran Sunreef 70 Power *Moondance* comprises a supreme combination of unparalleled onboard comfort, custom-made design, seaworthiness and low fuel consumption. This dark blue-hulled beauty was designed to take guests on unparalleled adventures in style without compromising on the comfort of cruising.

The yacht's interiors are a chic blend of white and grey tones with soft touches of pale wood and turquoise accessories. The vast saloon houses a dining area, a fully equipped galley, along with a comfortable seating area on the mezzanine level. *Moondance* comfortably sleeps up to 6 guests in three beautifully appointed double en suite cabins which emit a calm ambience created by the abundance of natural lighting and a soothing colour palette.

Moondance's outdoor deck areas provide plenty of options for indulging in a relaxing atmosphere while sunbathing on the front mattresses or the vast swimming platform in the aft, dining or simply lounging on the yacht's spacious aft cockpit and semi-enclosed flybridge. With a customized offer of charter itinerary and menu, along with a welcoming detail-oriented charter crew, this remarkable power yacht is a perfect choice for an exciting yachting holiday in New Zealand.

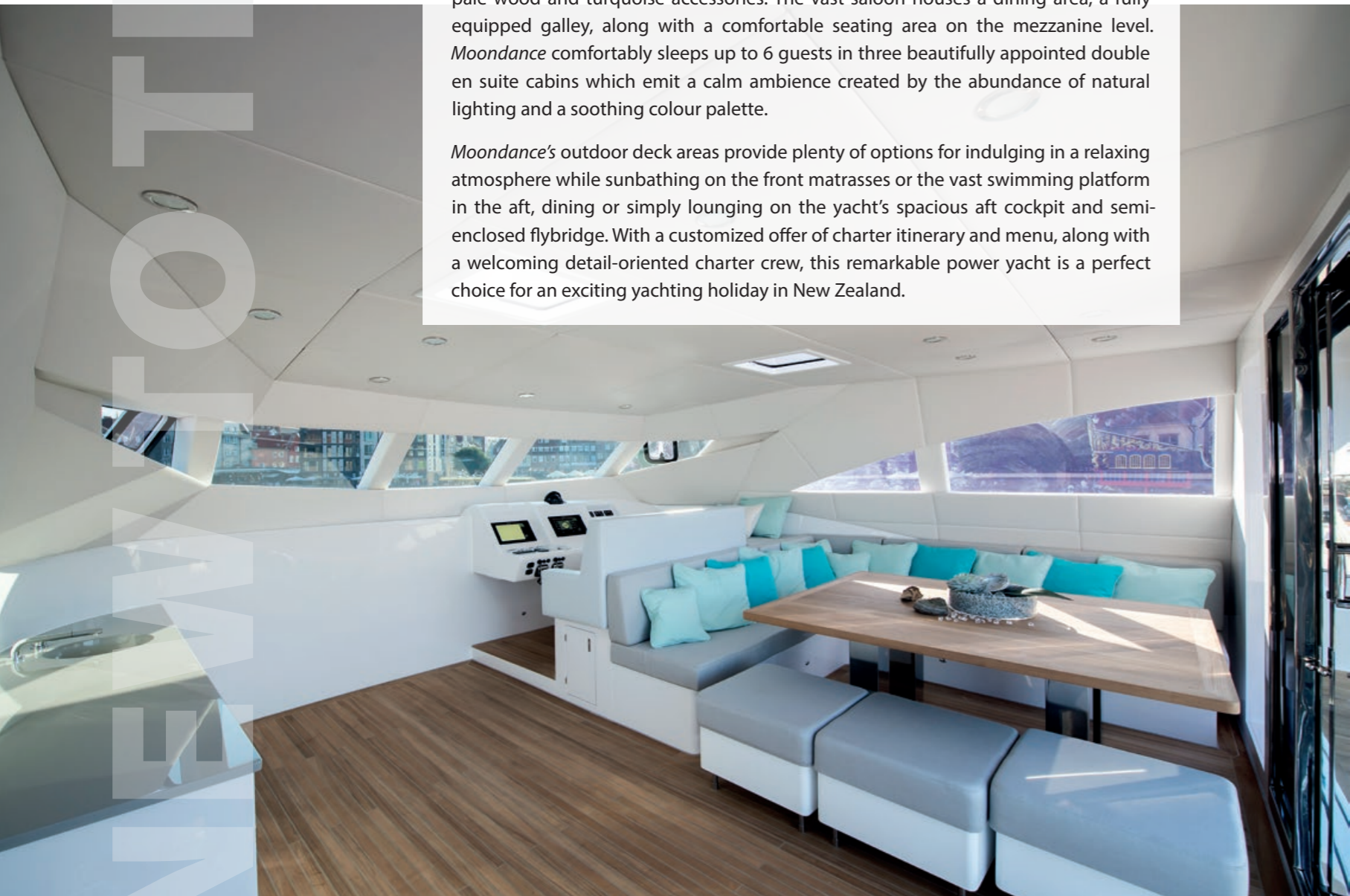

WEEKLY RATE AND SAILING AREA

Moondance

| | Location | Rate |
|-------------|-------------|------------------------------|
| 2018 / 2019 | New Zealand | from \$ 37.000 + expenses |

Croatia

Beauty and Diversity

WHETHER YOU ARE LOOKING FOR A QUIET VACATION AWAY FROM THE HUSTLE AND BUSTLE OF BIG CITY LIFE, OR LONGING FOR HISTORICAL, CULTURAL AND CULINARY DISCOVERIES, WHETHER YOU WANT TO BE A PART OF THE HOTTEST NIGHT-LIFE GLAMOUR AT THE BEST HARBOURS AND PARTY SPOTS, OR YOU ARE INTERESTED IN AN ISLAND-HOPPING ADVENTURE WITH AS MUCH BREATH-TAKINGLY BEAUTIFUL NATURE-GIVEN SPOTS AS POSSIBLE – A LUXURY YACHT CHARTER IN CROATIA IS A PERFECT MATCH FOR YOU.

Take a look at the sample itinerary prepared by Captain Chris Stollery, the Captain of Sunreef 74 *Calmao* which will be available for charter in Croatia this summer.



You will embark at Cavtat where *Calmao* and her crew will welcome you on board. Once all guests are ready to start their amazing holidays, the crew will set sails towards Dubrovnik where you can visit the Old Town, including the option of going up to Mount Srđ with a cable car to enjoy picturesque views of Dubrovnik and the Elaphiti Islands. At night, you can experience the captivating atmosphere of the Old Town created by its fantastic scenery, excellent fine dining restaurants and a multinational community.



After breakfast and a morning swim, there is an option of going back to the town or setting sails towards Olipa Island for a beautiful lunch stop to have a relaxing and joyful time. After lunch, *Calmao* will start heading to the island of Mljet and spend the night at Polače or Pomena, both being fantastic anchorages.



A perfect day for visiting the lake at the national park, enjoying the views and visiting the monastery. Mljet is famous for bikers so there is an option of renting bikes to go to the national park or organizing a minivan that will take you there. After a visit to the park, Chef Natalia will be ready with a delightful lunch before setting sails to Korčula, also known as Marco Polo's town, for overnight. On arrival, you can visit the old town and enjoy beautiful terraces, have a drink and indulge in an atmospheric evening before heading back to *Calmao*.



After breakfast, we will head towards Hvar and stop for lunch at the Pakleni Islands and move near town for overnight. Hvar is a place with the greatest night life, several shops, terraces and fantastic restaurants, which are worth visiting to experience an island mood to the fullest. In the mornings, there is a local market where our Chef loves to go and re-provision with fresh produce and sea food.





After breakfast with a view of the surrounding islands, we will be heading to Vis Island for lunch with a few options, including visiting a submarine pen and entering the Blue Caves before going to the Old Town for overnight and taking a nice walk through the sea front.



Setting sails towards Solta Island, known for its beauty and peaceful atmosphere, for lunch and overnight at the historic town of Trogir, declared a World Heritage Site by UNESCO.



A farewell breakfast before *Calmao* enters Split for disembarkation.

ON THE SUNREEF SIDE OF CHARTER

Luxurious Sunreef Yachts catamarans are world-renowned for the unique combination of onboard style and comfort, outstanding performance and superb seaworthiness. These qualities combined with the highest standard of service provided by a professional crew make them a perfect choice for the ultimate charter experience.





RICH SELECTION

Sunreef Yachts Charter fleet offers a rich selection of the most exclusive custom-made Sunreef Yachts catamarans ranging from 60 up to 102 feet in length. Our stunning sailing and power yachts available for charter in the most remarkable yachting destinations will satisfy the expectations of even the most demanding clientele.

Photo courtesy of Jim Raycraft Photography

DESTINATION OF CHOICE

Sunreef Yachts sailing and power catamarans are chartered in the most desired destinations worldwide, this is why our clients can enjoy the freedom of choice of their dream vacation spot. Whether a charter is planned for the winter or summer season, Sunreef Yachts Charter will find a perfect yacht in any preferred location.

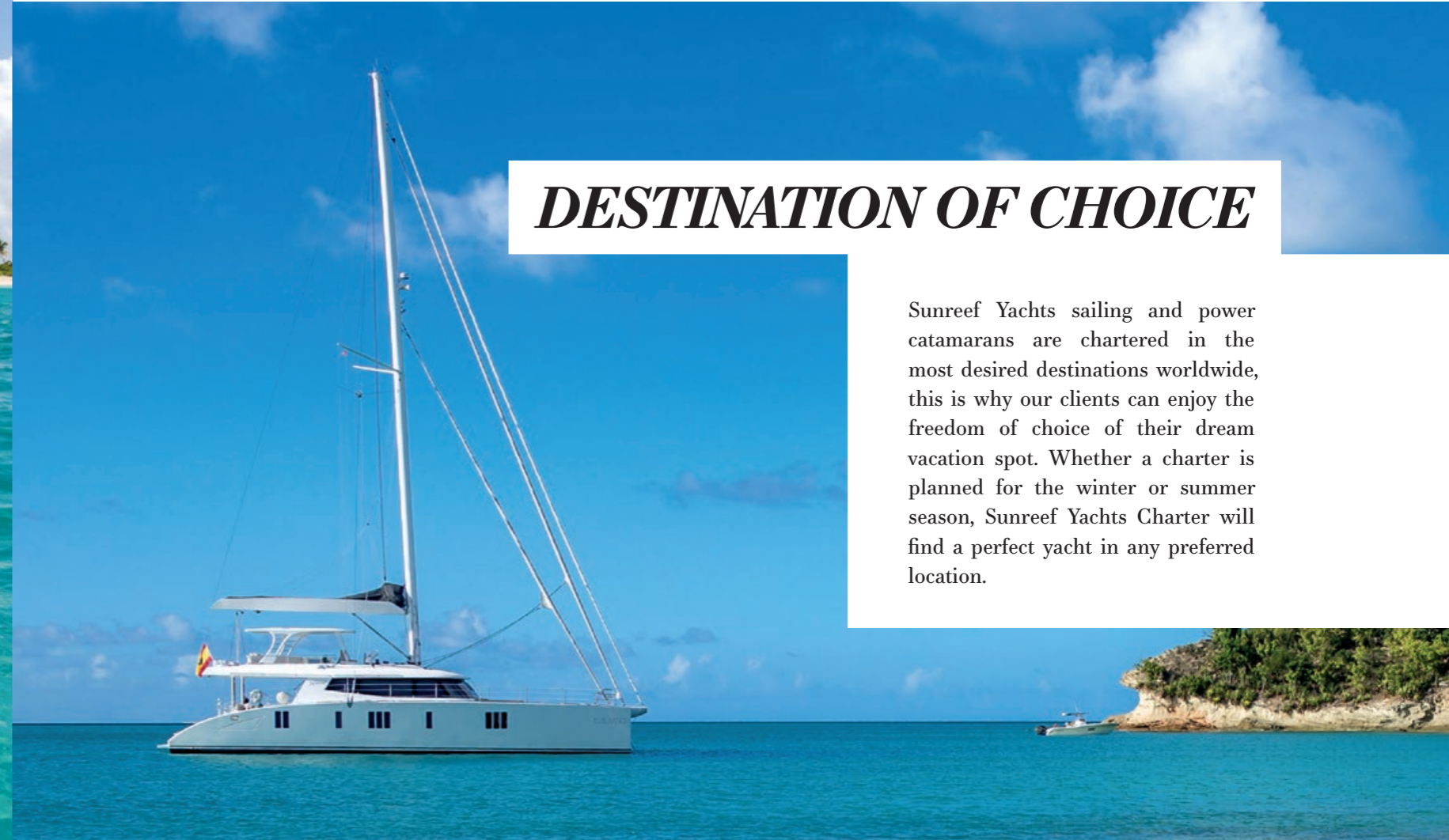

PERSONALIZED HOLIDAY



A family holiday, a get-together with friends or a romantic getaway – whatever the occasion, there is a perfect Sunreef Yachts catamaran for each and every one of them. Featuring an individual layout, a notable interior design and personalized exterior details, each Sunreef Yacht is unique. However, there is one thing all Sunreef Yachts catamarans have in common – they constitute the essence of pure luxury and yachting lifestyle, so highly valued by the enthusiasts of exclusive charter holidays tailored to individual needs.

GREAT OUTDOORS

With spacious outdoor areas offering a number of options for alfresco dining, relaxing in the shade or soaking up the sun, Sunreef Yachts are absolutely unbeatable in terms of leisure activities offered for the guests. Moreover, a rich assortment of water toys and water sport equipment available during the charter is a guarantee of fun-filled water activities enjoyed by all guests.





ONBOARD COMFORT

Each Sunreef Yachts catamaran offers the most comfortable accommodation in beautifully-appointed cabins with en suite bathrooms to provide guests with perfect conditions for regeneration after exciting activities during the day. Customized interior spaces also feature notable lounging and dining areas, ideal for indoor socializing and entertainment.

PROFESSIONAL SERVICE

Each Sunreef Yacht is chartered with an experienced crew who are fully committed to providing guests with the highest level of service. A professional chef, employed on each yacht, guarantees that the menu served to the guests does not only comply with the five-star restaurant standards but is also adapted to their individual preferences.



Choosing a Sunreef Yacht means pursuing a desire for a private yachting vacation which will leave you and your guests breathless. This is what Sunreef Yachts Charter is fully committed to – our main goal is to provide our esteemed clients with an extraordinary charter experience which, once acquired on a Sunreef, will become their favourite holiday activity. ■

 Sunreef Yachts Charter

Escape to your own seaside paradise



www.sunreef-charter.com
charter@sunreef-charter.com